



in

Nation

CAMPAIGN

SMITHVILLE CHRISTIAN HIGH



Message from the Administrator

It continues to be a privilege to serve the community that supports Smithville Christian High School. Students who begin their studies here quickly tell their family and friends how much they love it, teachers who have come into our employ are taken aback by the support they receive from their colleagues and by the respect of our students, and your administrator continues to love the place.

This is a school that is well positioned to be a blessing. Our learning community is engaging and rigorous, our reputation within our catchment area has become very positive, our communications practices have become strong, and our bursary program helps many families. We will continue to develop our strengths, but it is also time

to make sure that the building — particularly the front of the building — is in keeping with the vibrant character of the school.

I invite you to carefully read through this case for support in order to understand fully what the board and leadership feel led to accomplish after much prayer and strategic planning. We wish to remove any impediments which might compromise our ability to bless more young people with a Christian high school education that positions them to shape the culture in which they live for the sake of God's kingdom.

We look forward to our opportunity to talk to you about your continued support for our school by way of our *In Motion* Campaign.

May God bless us as we move forward in the light of his grace.

Ted Harris, Administrator



History of Our School

Smithville Christian High School opened its doors in 1980, in partnership with Hamilton District Christian High School, out of a desire to make Christian high school education accessible to families in West Niagara and East Haldimand County.

That first year, 160 students were enrolled. In 1990, the west wing of the school was added to provide for additional classroom space. In 1999, the Reaching Higher Campaign rallied the support community around the need for more and improved space. The result was a major expansion to the south end of the school, including a new side entrance and hallway, a double gym and locker rooms, a spacious shop and drafting lab, a drama room and a music room. In 2006, the Gateway Campaign completely erased the school's debt and we continue to remain completely debt-free. The campaign also provided much-needed HVAC upgrades to make our building more comfortable and economical. In 2011, we were joined by Beacon Christian High School of St. Catharines.

Today, our school is blessed with 213 students, representing 44 church communities and featuring 22 international students. Our students benefit from a rigorous academic program, innovative instructional approaches including extensive project-based learning, exemplary guidance and student support programs, an extensive shop



program, a renowned drama program, a vibrant spiritual life program, and a competitive athletics program.

Graduates receive the Smithville Christian High School diploma as well as the Ontario Secondary School Diploma. The majority of our graduates pursue university studies and most are received into the program of their choosing. The school's almost 2,200 alumni are serving the Lord locally and around the globe.

We employ 19 certified teachers who demonstrate a passion for their students, for their subject areas, and for serving Jesus Christ. They integrate their faith into their instructional practices, employ technologies extensively, commit to weekly research and development with their colleagues, and are members of Edifide, formerly known as the Ontario Christian School Teachers' Association.

Fast Facts

- Opened in 1980
- Current enrollment: 213
- Faculty and staff: 24
- Graduates: 2,200



MISSION & VISION

The mission of our school can be summarized in three words, now familiar to our supporters: **Belong. Believe. Succeed.**

We intend that all of our students feel enfolded in our learning community, that their gifts and uniqueness are celebrated, and that they are meaningful participants in a community of learners. We are pleased that our students feel this sense of belonging very strongly.

We also strive to make the Christian character of our school evident in every program area and in all school activities. Our spiritual life program, which includes weekly chapels with several student praise teams as well as a spiritual life coordinator, has thrived in recent years. Students are moving

toward a mature Christian perspective in their courses and are involved in enriching worship experiences which serve to solidify their belief in Jesus Christ as the central figure in history and in their lives.

Our school is dedicated to enabling student success. This commitment has greatly assisted in our students being accepted into their top program choices after high school. Students who have learning challenges are supported through our special needs program, and all students are carefully guided in their academic planning through our guidance program.

We give students a place to belong, we constantly challenge students in what it means to believe, and we do our very best to position students to succeed.

Message from the Board Chair



The opening of Smithville Christian High School was made possible by the Holy Spirit leading people to a passion for high school education where Christ would be central in all aspects of the program. Over the years, the students and supporting community have been blessed by Smithville Christian High School, and as

a board we strive to see that continue.

For ten years the school has benefitted from strategic planning, which has brought a host of results from two five-year plans. This process has always been bathed in prayer as we have sought God's guidance moving into the future. This constant planning has been fruitful, bringing a school that is debt-free, a long string of positive annual budgets, and a spiritual life program that has been a blessing to our school. That same strategic planning process has identified a need for improved curb appeal, improved reception and administrative function, and better affordability in an effort

to have Christian education possible for all.

In 1999, we conducted the Reaching Higher Campaign, and in 2006, the Gateway Campaign. Both campaigns had a major impact on the school's current ability to bless young people and their families.

As an extension of our strategic plan, we conducted a feasibility study this past fall which indicated strong support for a capital campaign. In December, the board unanimously approved the *In Motion* Campaign for 2014. Funds raised through the campaign will go to school entryway renovations, some additional building improvements and the bursary fund, with a total campaign target of \$1.4M.

I invite you to prayerfully consider your contribution to this campaign. I ask that all of us be involved in this campaign, whether in prayer, canvassing or giving. Each of you plays an important part in supporting and building Christian education. Let us fix our eyes on Jesus, that he may lead us as we follow God's command to instruct his children in the ways of the Lord.

May we seek to give God the glory.

Al Elmers, Board Chair



PLANNING

As we begin the campaign, we do so based on the work of the Pre-Campaign Team, which was busy throughout the fall term. The team met often, prayed much and worked through input from discussions with many of our supporters.

The hard work of the Pre-Campaign Team followed a Campaign Feasibility Study conducted by The Dennis Group Inc. in fall 2013. The results of their work culminated in a final report to the board. This report contained a close investigation of the strengths, challenges, opportunities and threats, which came to the forefront through the multitude of interviews conducted through the Feasibility Study. Though there are dozens of pages of material, the report indicated very strong support from our donors — both for our school in general as well as for the campaign being planned. The Feasibility report indicated that the goals of the campaign resonate with supporters and that a \$1.4M financial target is very much

within reach. The board deliberated on all of the recommendations from this report and made the decision to move ahead with the recommended campaign.

We are profoundly grateful for the work of this committee as well as those who helped us by giving time for an interview. We are also deeply encouraged by what we heard about our school from those who were interviewed. We feel the Lord speaking to us through the wisdom of our supporters and Pre-Campaign Team, and we feel led to pursue this campaign as a stewardly investment in the future of our school.

Pre-Campaign Team members: Fred Breukelman, Al Elmers, Caroline Eyk, Ted Harris, Wayne Schilstra (Chair), Lorraine Vermeer.

In Motion,

THE THINKING BEHIND THE NAME

Our school is in motion. This is not a place where people come to sit still. Education is changing, and our teachers and students are constantly adjusting to the opportunities of 21st century learning.

Teachers are learning new ways of guiding and assessing the learning of students, and students are accustomed to more authentic learning

activities and increased engagement with a wider culture. New families are inquiring frequently; percentages of students coming from our partner schools are high, and we frequently enrol students who transfer from other high school situations. We are now enjoying students from more diverse backgrounds; we are represented by 44 local churches, and 10% of our students are from international communities. This represents significant movement compared to a decade ago.

Just as our learning more frequently engages our community, we also desire to be a place where the community meets. Our building is regularly used by a Christian dance company, sports leagues, Canadian Blood Services and a host of other community groups, in addition to the church that meets here every week. We enjoy seeing our building in constant use. The more we engage our community, the better positioned we will be to bless families from that community with a Christian high school education.

Much of this motion depends on a building that is attractive and welcoming. Though the building is clean and in good repair, the appearance of our building and its reception areas is not considered attractive and welcoming. After decades of talking about how the front of the school needs serious attention in order for us to properly welcome our community and reflect the dynamic environment inside the building, it is time to get moving on this goal. This campaign represents the positive motion of our school and therefore felt the *In Motion* Campaign was a befitting name. Let's get it moving together!



The Goals

Our school has succeeded in welcoming students from a wide range of Christian communities throughout our drawing area. We consider this to be a step in the right direction as we follow the Lord's leading in becoming the school of choice for all sincere Christian families in our region. In maintaining this positive motion, we seek to remove anything that is getting in the way of allowing the Lord to use us as a blessing to families.

We have been working at removing hurdles for some time. Here are some actions that we have taken in recent years to be more accessible to our community:

Improving communications: We now have a much more notable presence because of our web site and various social media (our Echoes newsletter, Facebook, Youtube, blog, Twitter and Edsby learning management tool).

Adjusting our language: We have deliberately adjusted our language to ensure that we do not put up barriers. We now call our school "Smithville Christian" as opposed to using an acronym, we avoid ethnically exclusive language, and we avoid assuming that the one with whom we are speaking has a long history in Christian education.

Improving our financial support mechanisms: We have adjusted our tuition structure to ensure that tuition fees cover the cost of education and that annual drives are used exclusively to help families who need tuition support.

Emphasizing hospitality: Our students and staff have been trained to receive guests with a hospitable spirit. When people visit our school, they leave encouraged.

ABOUT THE PROJECTS

The *In Motion* Campaign is designed to remove hurdles and to throw the doors wide open to a community of people who are yet to be blessed by Christian secondary school education. Through the campaign we will redesign features of our building to better express the vibrant and dynamic character of our school. The campaign will also ensure that all families have the financial means to benefit from the quality Christian education provided at Smithville Christian High School.

Renovation

Addressing the appearance of our school: To continue to open our doors and attract the community, the school needs to have a more welcoming curb appeal. Lord willing, the campaign will enable us to create an obvious and attractive main entrance to the school that will unify the look of the exterior front section of the building and create a professional appearance that represents how we approach education inside. This includes a colour adjustment to all the grey brick near the front of the school, as well as modest adjustments to the exterior walls of the entire front of the school.

Enhancing our front entrance: The front entrance is clearly the place where the character of our school is communicated — where first impressions are made, where visitors are greeted, where future and past parents drop by, where students gather, and where the community enters for evening classes. It is our goal for a welcoming, open and bright facility where education is Christ-centred, collaborative and innovative. The current foyer, which is constricting and dark with low ceilings, will be transformed into a bright and attractive area where students will collaborate on their projects, where their work will be exhibited, and where God glorifying artistic expressions will engage every visitor. The main office spaces that are now cramped and awkwardly configured will be moved and reconstructed, allowing for attractive and ample reception and administrative office areas. We hope for offices that give room for our leaders to do their work but also to meet with and support students and engage guests in conversations about the vision of our school. To accommodate these changes, the guidance offices will be moved to a new space which will be created in the courtyard between the original building and the west wing.

Providing better space for our spiritual life program: Our chapels have become the focal point of each week at school and have brought Jesus Christ into the centre of our expression of community. Our dream is to

move our chapels out of the gym and into a redesigned space which will serve as both our cafeteria and our chapel hall. Our current cafeteria will include a stage and other upgrades to enhance our weekly worship, and provide an excellent venue for drama productions and school and community meetings.

Bursary Fund

Our bursary fund exists to enable families who struggle to pay tuition fees. Lord willing, this campaign will help us grow the fund so that we may extend the blessing of Christian secondary school education to many more students who would not otherwise experience it. Our Foundation has become more successful every year since its inception in 1997, and now provides a significant annual injection of funds into our bursary program. Our bursary funds are held with our Smithville Christian High Foundation in order to maximize the potential for interest earned and we are very pleased with the results garnered for us.

The bursary program includes three different bursaries:

Discover the Blessing Bursary — provides encouragement for families new to Christian education through a first-year tuition rate which is equivalent to the rate paid by families who have children in a Christian elementary school.

Bridge Bursary — awarded to eligible families who are paying tuition at both elementary and high school and based on income and family size.

Need Based Bursary — available to families with particular economic challenges and based on need, determined through an interview process.

Every Gift Makes it Possible!

A capital campaign of \$1.4M is a tall task. Its success will depend on our faith in God and His guidance to each and every one of us to help us to find a way to make a sacrificial gift to the campaign. Every contribution to the campaign is a significant one and together, every gift will ensure our campaign is a success and that the next 3 decades at Smithville Christian High School will be as thriving as the last. Thank you for prayerfully considering how you too can be a part of the future of Smithville Christian High School and our *In Motion* Campaign.

The *In Motion* Campaign will bring many other positive outcomes for our school as well. It will help us build new relationships, strengthen existing ones and reconnect with the past. All this will be possible by placing our faith and trust in the God who has provided us with so many resources for us to share generously with hearts of thanksgiving.

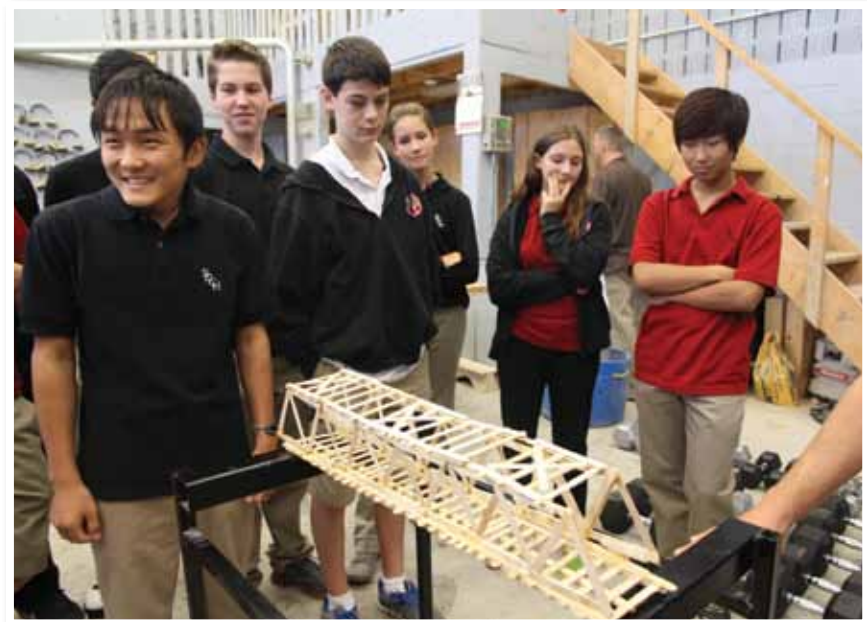

Canada Revenue Agency provides tax credits for donations to charitable organizations. Your full donation to the Smithville Christian High School *In Motion* Campaign is eligible for both an income tax receipt and a tax credit. In the majority of cases, the donation tax credit is approximately 40% of the total donation, therefore your actual cost is only 60% of the donated amount. The following chart shows some examples:

Total Gift Over 3 Years	Annually	Monthly	Tax Credit Based on 40%	Actual Cost of Gift	Actual Cost Annually	Actual Cost Monthly
\$150,000	\$50,000	\$4,167	\$60,000	\$90,000	\$30,000	\$2,500
\$100,000	\$33,333	\$2,778	\$40,000	\$60,000	\$20,000	\$1,667
\$75,000	\$25,000	\$2,083	\$30,000	\$45,000	\$15,000	\$1,250
\$50,000	\$16,667	\$1,389	\$20,000	\$30,000	\$10,000	\$833
\$30,000	\$10,000	\$840	\$12,000	\$18,000	\$6,000	\$500
\$20,000	\$6,667	\$556	\$8,000	\$12,000	\$4,000	\$333
\$15,000	\$5,000	\$417	\$6,000	\$9,000	\$3,000	\$250
\$10,000	\$3,333	\$278	\$4,000	\$6,000	\$2,000	\$167
\$7,500	\$2,500	\$208	\$3,000	\$4,500	\$1,500	\$125
\$5,000	\$1,667	\$139	\$2,000	\$3,000	\$1,000	\$83
\$3,000	\$1,000	\$84	\$1,200	\$1,800	\$600	\$50
\$1,000	\$333	\$28	\$400	\$600	\$200	\$17
\$750	\$250	\$20	\$300	\$450	\$150	\$12,50

\$1.4M Project Cost Breakdown

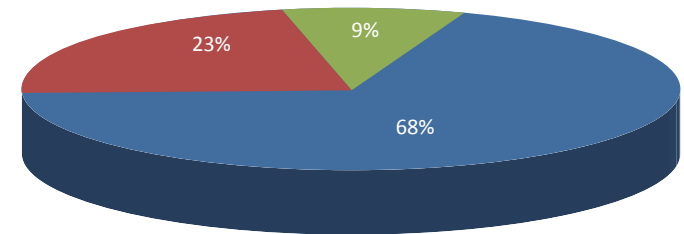

■ Renovations \$950,000
■ Bursary Fund \$325,000
■ Campaign Costs \$125,000

elevations



NORTH ELEVATION

SCALE 1:100



EAST ELEVATION

SCALE 1:100

SMITHVILLE CHRISTIAN HIGH SCHOOL
6488 SMITHVILLE ROAD - SMITHVILLE - ON



plans



FLOOR PLAN - FOYER/ADMINISTRATION ADDITION

SCALE 1:100

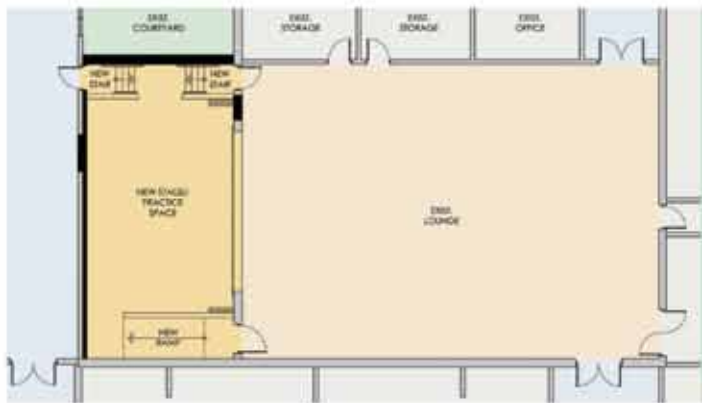

FLOOR PLAN - STAGE ADDITION

SCALE 1:100



KEY PLAN

SMITHVILLE CHRISTIAN HIGH SCHOOL
6488 SMITHVILLE ROAD - SMITHVILLE - ON



Testimonials

"I praise God for His absolute blessing and the joy in my heart to be able to send our kids to Christian educators. Our kids bounce in the door, anxious and excited to share their day with us! Their heartfelt prayers of praise and thanksgiving tell the story!"

Jen Shirton, Parent

"Smithville Christian High School has been such a blessing for me. This school is so welcoming, and I've always said that it feels like a big family, where you will always be accepted. No matter what, I am so thankful for the things I have learned here. And I know I will carry them with me for the rest of my life."

Robyn Brinkert, Class of 2013

"Smithville Christian prepared me. It was the beginning of a life-long journey of learning how to integrate faith and life together. Smithville Christian prepared me to think critically about how we live in the world and how we engage the world. It planted a seed in me."

Ken Dam, Class of 1998

"I've learned so much here at Smithville Christian High School and I am sad I won't be returning next year, but I will look back on my high school experience as positive. I have built amazing relationships with my friends, teachers and most importantly, God. Thank you!"

Amanda Regnerus, Class of 2013

"Teaching at Smithville Christian High School has been an enormous blessing in my life. This is not a school where we "get" to teach from a Christian perspective or learn in the light of Biblical Truth. We don't simply 'get' to do these things, we are "compelled" to by the leading of the Holy Spirit to the Glory of God in the name of Jesus Christ. From day one in September of 1980, that has been my experience of what it means to be a part of the Smithville Christian High School community, both as staff member and as a parent. And it has been abundantly apparent that such an experience has not been mine alone. We started as a small school with a fairly young staff (with some seasoned teachers to help mentor along the way). I was new to Christian education, so discovering what Christian education was all about was a step-by-step process for me. I found that seeing my curriculum and teaching from a Christian perspective was incredibly liberating. When what you teach and what you talk about, and how you interact with colleagues and students are all based upon the truth of God's Word, and seasoned by that truth — the blessings of God's presence becomes a living reality. And this, I believe, is a blessing for all who are engaged in our school community, and of course in a much larger sense, following Christ."

Gord Park, Staff Member



6488 Smithville Road
P.O. Box 40, Smithville, ON L0R 2A0
P 905.957.3255 F 905.957.3431
www.smithvillechristian.ca

